

# WINEFILTER 6" Hollow Fiber Cartridges

## Hollow Fiber Crossflow Cartridges for Wine Filtration

### Product Description

Membrane Type	Microfiltration
Membrane Material	Polysulfone
Regulatory Status	Compliant with US FDA CFR Title 21 and EC Reg. Nos. 1935/2004, and 10/2011
Housing Construction:	Polysulfone shell and end caps
Storage Solution	Glycerin

### Specifications

Model	Part Number	Active Membrane Area		Fiber Inside Diameter	
WINEFILTER 6043	0720291	130 ft <sup>2</sup>	12.1 m <sup>2</sup>	54 mil	1.4 mm
WINEFILTER 6060	0720293	185 ft <sup>2</sup>	17.2 m <sup>2</sup>	54 mil	1.4 mm

### Operating & Design Information\*

Maximum Inlet Pressure	40 psi (2.7 bar)
Maximum Transmembrane Pressure	25 psi (1.7 bar)
Maximum Feed Side Pressure Drop	30 psi (2.1 bar)
Maximum Backflush Pressure	20 psi (1.4 bar)
Recommended Backflush Interval	15 to 30 minutes
Maximum Operating Temperature	104°F (40°C) @ pH 6
Maximum Cleaning Temperature	140°F (60°C)
Allowable pH (Cleaning)	1.5 – 13.0 @ 104° F (40°C)

### Nominal Dimensions

Model	WINEFILTER 6043	WINEFILTER 6060
A	43" (1,092 mm)	60" (1,524 mm)
B	6.67" (169.4 mm)	6.67" (169.4 mm)
C	38 <sup>1</sup> / <sub>16</sub> " (982.7 mm)	55 <sup>5</sup> / <sub>8</sub> " (1,413 mm)
Permeate Connection	1½" sanitary	
Process Connection	6" sanitary	

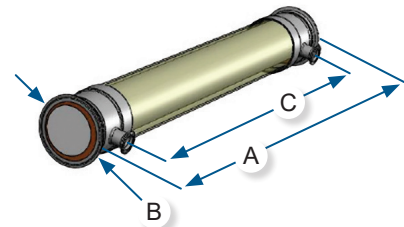

**Hardware**

Item	Part Description	Part Number
1	6" gasket	0090424
2	6" Process Cap adapter	0040321
3	6" Coupling	1020262
4	2½" Cartridge Gasket EPDM	0090411
	2½" Cartridge Gasket BUNA	0090410
5	2½" Coupling	0210468
6	1" Gasket EPDM	0090394
	1" Gasket BUNA	0090395
7	1" Coupling	0210465

Process pass kit for 6" cartridge with EPDM gaskets is available. KMS part number is 1007055.

**Lubricants**

For cartridge installation, use only water or glycerin to lubricate seals. The use of petroleum or vegetable-based oils or solvents may damage the cartridge and will void the warranty.

**Exposure to Chemical Oxidants**

Exposure to chemical oxidants for thorough cleaning and sanitization may prove necessary and useful.

- Chemical oxidants commonly used in food applications include peracetic acid blends, hydrogen peroxide, and sodium hypochlorite. Please consult KMS for recommended addition rates, frequency of use, and tolerance.
- Potassium metabisulfite (without catalyst such as cobalt) is the preferred chemical to eliminate residual chlorine or similar oxidizers prior to processing the feed stream.

**KMS Capability**

KMS is the leader in crossflow membrane technology, manufacturing reverse osmosis, nanofiltration, microfiltration, and ultrafiltration membranes and membrane systems. The industries served include food, dairy and beverage, pharmaceutical, biotechnology, water and wastewater, semiconductors, automotive, chemical and general manufacturing. KMS adds value by providing top quality membrane products and by sharing its experience in the design and supply of thousands of crossflow membrane systems worldwide.

**Service and Ongoing Technical Support**

Koch Membrane Systems, Inc. has an experienced staff of professionals available to assist end-users and OEMs for optimization of existing systems and support the development of new applications. Along with the availability of supplemental technical bulletins, Koch Membrane Systems, Inc. also offers a complete line of KOCHKLEEN® cleaning chemicals and can assist optimizing your cleaning regime.

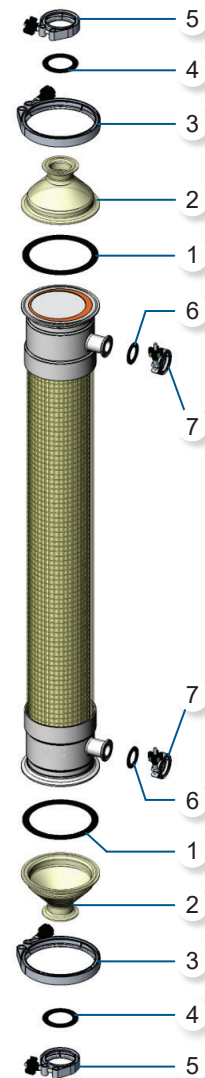

**Koch Membrane Systems, Inc.**

850 Main Street, Wilmington, MA 01887-3388  
 Main: +1-978-694-7000 • Fax: +1-978-657-5208 • Toll Free: +1-888-677-5624